

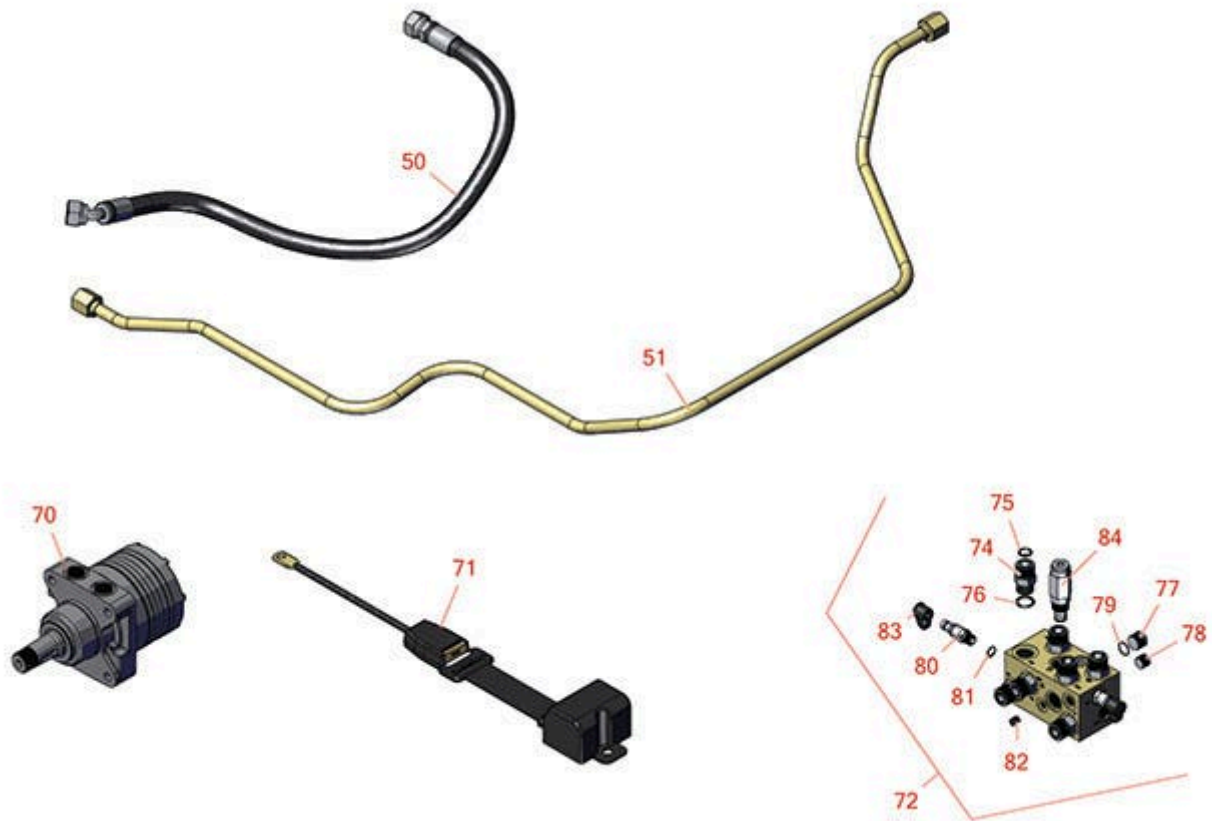

Replaces Toro Reelmaster 5410-D Parts

Traction Unit

All Wheel Drive Kit - Model 03671



All original equipment manufacturers names and part numbers are used for identification purposes only, and we are in no way implying that our products are original equipment parts. Prices subject to change without notice.



Replaces Toro Reelmaster 5410-D Parts

Traction Unit

All Wheel Drive Kit - Model 03671



Item No	R&R Part No.	OEM Part No.	Description	Qty Req	Order Quantity
Hoses					
50	R106-3662	106-3662	Hydraulic Hose Assy	4	
50	R108-7645	108-7645	Hydraulic Hose Assy	1	
51	R108-7622	108-7622	Tube Assy	1	
51	R108-7623	108-7623	Tube Assy	1	
51	R108-7624	108-7624	Tube Assy	1	
51	R108-7625	108-7625	Tube Assy	1	
51	R108-7626	108-7626	Tube Assy	1	
Other Parts Available					
70	R107-4544	107-4544	Hydraulic Motor Assy - LH	1	
70	R110-0901	110-0901	Hydraulic Motor Assy	1	
71	R150848	100-4928, 110-0413, 110-9720, 95-8910	Belt-Seat	1	
72	R108-1825	108-1825	Hydraulic Manifold Assy	1	
74	R340-7	340-7	Adapter	7	
75	R237-65	237-65, 237.65	O-Ring	7	
76	R237-80	237-80, 327-80	O-Ring	7	
77	R106-1027	106-1027	Plug-Hyd	1	
78	R106-1026	106-1026	Plug-Hyd	6	
79	R237-79	237-79	O-Ring	1	

All original equipment manufacturers names and part numbers are used for identification purposes only, and we are in no way implying that our products are original equipment parts. Prices subject to change without notice.



Replaces Toro Reelmaster 5410-D Parts

Traction Unit

All Wheel Drive Kit - Model 03671



Item No	R&R Part No.	OEM Part No.	Description	Qty Req	Order Quantity
80	R59-7410	59-7410	Tip-Nipple	2	
81	R237-42	237-42, 31-4160	O-Ring	2	
82	R106-1025	106-1025	Plug - Hyd	4	
83	R354-79	354-79	Cap-Dust	2	
84	R110-8882	110-8882	Relief Valve - Crossover	1	

All original equipment manufacturers names and part numbers are used for identification purposes only, and we are in no way implying that our products are original equipment parts. Prices subject to change without notice.