

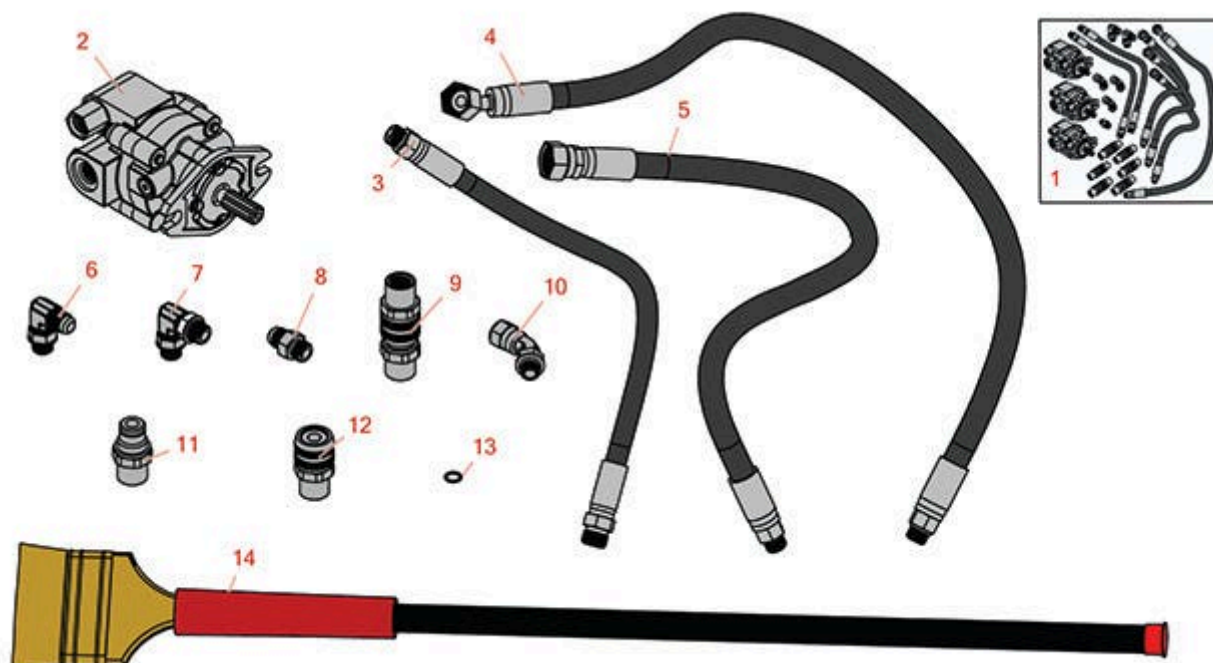

# Replaces Toro Greensmaster 3050 Parts

Traction Unit - Model 04351

Back Lapping Kit



All original equipment manufacturers names and part numbers are used for identification purposes only, and we are in no way implying that our products are original equipment parts. Prices subject to change without notice.



## Replaces Toro Greensmaster 3050 Parts

Traction Unit - Model 04351

Back Lapping Kit



Item No	R&R Part No.	OEM Part No.	Description	Qty Req	Order Quantity
1	<b>R92-9656</b>	63-4960, 92-9656	Backlap Kit - Fits GM3000 Series & R&R	1	
2	<b>R54-9510</b>	54-9510, 54-9520	Hydraulic Motor	3	
3	<b>R70-9940</b>	63-4970, 70-9940	Hose Assy - Pressure 29 in	2	
4	<b>R70-9960</b>	63-4990, 70-9960	Hydraulic Hose Assy - Pressure 33.5 in	1	
5	<b>R70-9950</b>	63-4980, 70-9950	Hydraulic Hose Assy - Return 29.25 in	3	
6	<b>R353-374</b>	353-374	Elbow - 90 Deg	1	
7	<b>R54-9540</b>	54-9540	Hydraulic Fitting - 90 Adj	2	
8	<b>R353-384</b>	353-191, 353-384	Hydraulic Fitting - Striaight	1	
9	<b>R92-9657</b>	92-9657	Quick Cupling Assy - Body and Nose	6	
10	<b>R54-9530</b>	54-9530	Hydraulic Fitting - 45 Adj	3	
11	<b>R92-9658</b>	92-9658	Quick Coupling - Nose	6	
12	<b>R92-9659</b>	92-9659	Quick Coupling - Body	6	
13	<b>R237-22</b>	107-8844, 237-22, 237-78	O-Ring	2	
13	<b>R237-42</b>	237-42, 31-4160	O-Ring	18	
14	<b>R29-9100</b>	29-9090, 29-9100	Backlapping Brush	1	

*Detail Description: Lapping compound application brush features aluminum handle and 2" wide brush.:*

All original equipment manufacturers names and part numbers are used for identification purposes only, and we are in no way implying that our products are original equipment parts. Prices subject to change without notice.