



# Replaces R&R Products Sand Max 518

## Parts

*Attachments*

*Weeder Tine Toolbar*

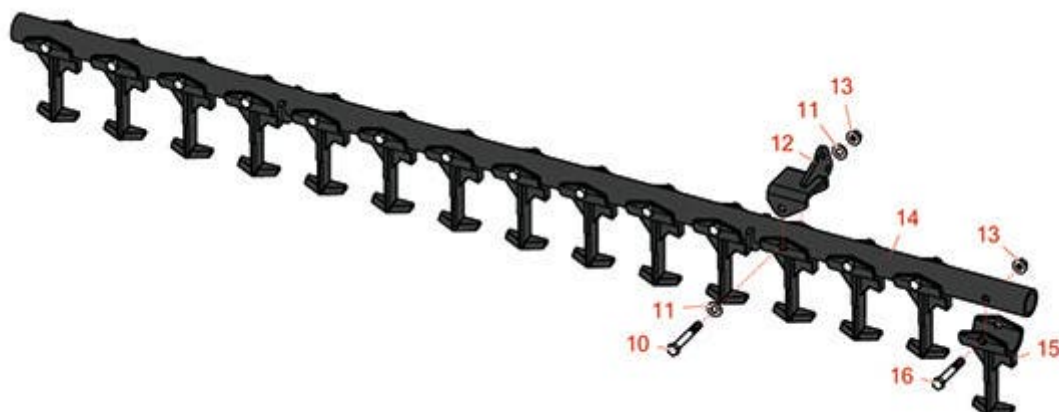

All original equipment manufacturers names and part numbers are used for identification purposes only, and we are in no way implying that our products are original equipment parts. Prices subject to change without notice.



# Replaces R&R Products Sand Max 518

## Parts

Attachments

Weeder Tine Toolbar



Item No	R&R Part No.	OEM Part No.	Description	Qty Req	Order Quantity
10	<b>R323-14</b>	323-14, R01-150-0840, R01-178-0624, R20-55-AD, R21-196-AMD, R30-8750, R30-8970, R3224-10	Bolt - Hex HD 3/8-16 x 3	1	
11	<b>R453011</b>	3256-24, 453011, R01-166-0100, R01-166-0120, R01-166-0270, R01-166-0500, R01-166-0600, R01-166-0620, R132-4593, R237-12, R24-10-AD, R24-11-AD, R24-11-BD, R24-12-AD, R24-12-BD, R30-9310, R32-8190, R3256-24, R3256-3, R3256-36, R3256-4, R47-9950	Washer - Flat 3/8 SAE Y/Zinc	2	
12	<b>R112-6468-03</b>		Bracket Assy - Tool Bar	1	
13	<b>R3296-39</b>	3296-39, R32127-25, R32128-36, R3296-17, R3296-22, R915663P, R99-7443	Locknut - 3/8-16 Nylon	15	
14	<b>R108-4527-03</b>		Tool Bar Assy	1	
15	<b>R110-0260-03</b>		Weeder Tine - Hardened	15	

All original equipment manufacturers names and part numbers are used for identification purposes only, and we are in no way implying that our products are original equipment parts. Prices subject to change without notice.



# Replaces R&R Products Sand Max 518 Parts

*Attachments*

*Weeder Tine Toolbar*



Item No	R&R Part No.	OEM Part No.	Description	Qty Req	Order Quantity
16	R400274	R01-178-0626, R112-7161, R3224-11, R323-20	Bolt - Hex HD 3/8-16 x 2-1/2 GR5	14	

All original equipment manufacturers names and part numbers are used for identification purposes only, and we are in no way implying that our products are original equipment parts. Prices subject to change without notice.