

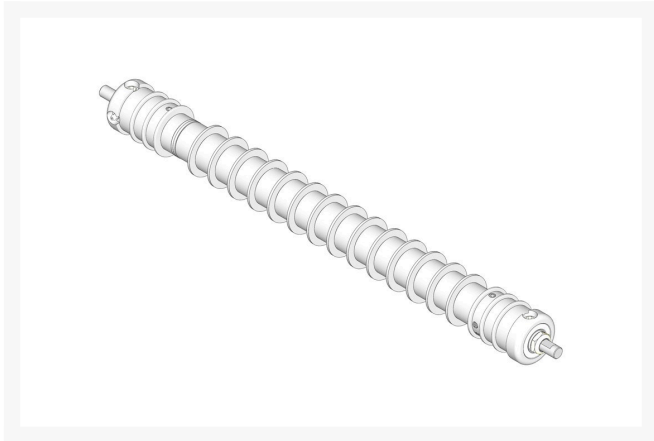

Roller - Grooved Repairable Steel

RLMAA356RG



Details

Constructed with a through shaft and greasable tapered bearings for extended life, this roller can be repaired by unscrewing the ends and replacing the series of washers and spacers. Body Length: 27-1/2" & Shaft Length: 31-3/4"

Replaces

R&R Products RLMAA356G

Specifications

Manufacturer	R&R Products
Overhaul Kit No.	R100135
Roller Body Diameter	2.75 in
Weight (lbs)	20 lb

Fits Models

Ransomes 213, 350 & 5/7 Fairway

Replacement Parts

R100135	Overhaul Kit - Roller
R500534	Bearing - with Cup
R150670	Roller End - 2-3/4 Threaded
R328059	Shaft - Grooved Roller
R150672	Washer - 2-3/4 Roller
R150676	Spacer - 2-3/4 Dia x 1-1/4 L
R150678	Spacer - Grooved Roller 3/4
R150676A	Spacer - 1/8
R150691	Screw - Set Nyloc

Pekerti Jaya Sdn. Bad

45 Jalan Industri USJ 1/5, Taman Perindustrian USJ 1 Subang Jay, 47600
603-80216684

<https://pekertijaya.rrproducts.com/>



Roller - Grooved Repairable Steel

RLMAA356RG



	3/8-16 x 3/8
R170714	Fitting - Pressure Relief
R302-5	Fitting - Grease
R253-122	Seal
R254-79	Cup - Bearing
R254-78	Tapered Bearing Cone
R150674	Sleeve - Wear 3/4 Plated
R253-117	Seal - Outer Triple Lip
R3296-15	Locknut - 3/4-16 Nylon Jam

Pekerti Jaya Sdn. Bad

45 Jalan Industri USJ 1/5, Taman Perindustrian USJ 1 Subang Jay, 47600
603-80216684

<https://pekertijaya.rrproducts.com/>