



Replaces Exmark Lazer Z E-Series Parts

Zero-Turn Mower with 72in Deck - Model LZE751GKA724A1

& LZE751GKA724A3

Caster Wheel

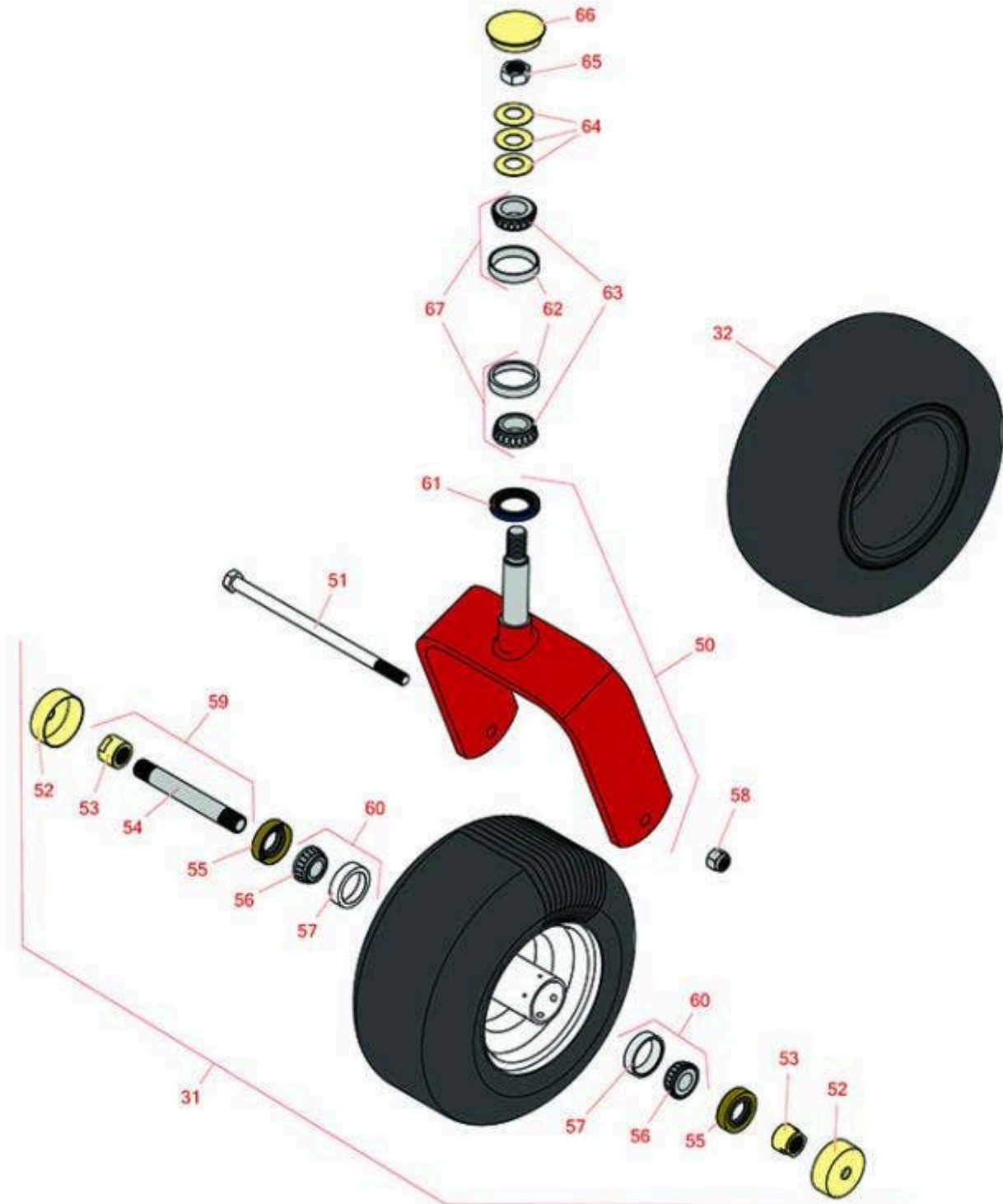

All original equipment manufacturers names and part numbers are used for identification purposes only, and we are in no way implying that our products are original equipment parts. Prices subject to change without notice.



Replaces Exmark Lazer Z E-Series Parts

Zero-Turn Mower with 72in Deck - Model LZE751GKA724A1

& LZE751GKA724A3

Caster Wheel



| Item No | R&R Part No. | OEM Part No. | Description | Qty Req | Order Quantity |
|--|-------------------|--|--|---------|----------------|
| Tires | | | | | |
| 31 | R109-9127 | 109-9127 | Tire & Wheel - 13x6.50-6 Flat Free | 2 | |
| 31 | R117-0361 | 117-0361 | Wheel & Tire Assy 13x6.50-6 Pneumatic | 2 | |
| 32 | RCT5121861 | 1-523009, 125-5581, 126-5959 | Tire - 13x6.50-6 Nhs (4 Ply) Carlisle Smooth | 2 | |
| Other parts | | | | | |
| 50 | R116-8888 | 103-1474-01, 116--6707-01, 116-6707-01 | Fork - Caster 7.875 in Inside | 2 | |
| 51 | R325-39 | 325-39 | Bolt - Hx HD 1/2-13 x 9 1/2 | 2 | |
| 52 | R103-2768 | 103-2768 | Guard - Seal | 4 | |
| 53 | R103-3051 | 103-3051 | Spacer - Nut - Hardened | 4 | |
| 54 | R103-5156 | 103-5156 | Axle- Caster | 2 | |
| 55 | R103-0063 | 103-0063 | Seal - Grease | 4 | |
| 56 | R254-78 | 1-633585 | Tapered Bearing Cone | 4 | |
| 57 | R254-79 | 1-633584, R & R ONLY | Cup - Bearing | 4 | |
| <i>Tech Note: Use R254-79M installation mandrel to properly install race.:</i> | | | | | |
| 58 | RF5003 | 3296-23 | Locknut - ESNA 1/2-13 | 2 | |
| 59 | R126-5361 | 126-5361 | Axle Assy - with Bushing - Caster | 2 | |
| 60 | R500534 | 1-633585, R & R ONLY | Bearing - with Cup | 4 | |
| 61 | R116-5647 | 116-5647, R & R ONLY | Seal - Grease | 2 | |

All original equipment manufacturers names and part numbers are used for identification purposes only, and we are in no way implying that our products are original equipment parts. Prices subject to change without notice.



Replaces Exmark Lazer Z E-Series Parts

Zero-Turn Mower with 72in Deck - Model LZE751GKA724A1

& LZE751GKA724A3

Caster Wheel



| Item No | R&R Part No. | OEM Part No. | Description | Qty Req | Order Quantity |
|---------|------------------|--------------|------------------------------------|---------|----------------|
| 62 | R254-72 | 1-543508 | Cup - Bearing | 4 | |
| 63 | R254-94 | 1-543509 | Tapered Bearing Cone | 4 | |
| 64 | R1-633508 | 1-633508 | Washer - Spring Disc | 6 | |
| 65 | R3296-51 | 3296-51 | Nut - Nylon Lock 3/4-10 Gr 8 | 2 | |
| 66 | R103-4882 | 103-4882 | Grease Cap - Castor | 2 | |
| 67 | R500596 | R & R ONLY | Tapered Bearing Set - Cup and Cone | 4 | |

All original equipment manufacturers names and part numbers are used for identification purposes only, and we are in no way implying that our products are original equipment parts. Prices subject to change without notice.